



2 Brabham Mews, Moorside Road,
Sinton, Manchester, M27

£1,350 per month

Unfurnished



your-move.co.uk

2 Brabham Mews, Moorside Road, Swinton, Manchester, M27
£1,350 per month Unfurnished

*** Zero Deposit Scheme Available *** Video Tour Available *** Sought after Location ***
This STUNNING family home has been maintained to a top condition and is sure to catch a lot of early attention! The property briefly comprises; Spacious Living Room, Dining Room, Modern Kitchen, Three double bedrooms and family bathroom. The property further benefits Private Garden to rear and additional off road parking.
EPC Grade D.
Salford City Council, Band C, £1,871 PA.

Description

*** Zero Deposit Scheme Available *** Video Tour Available *** Sought after Location ***
This STUNNING family home has been maintained to a top condition and is sure to catch a lot of early attention! The property briefly comprises; Spacious Living Room, Dining Room, Modern Kitchen, Three double bedrooms and family bathroom. The property further benefits Private Garden to rear and additional off road parking.
EPC Grade D.
Salford City Council, Band C, £1,871 PA.

Our View

This property would suit couples, families and professionals.

Location

Located close to the beautiful villages of Monton and Worsley which offer an abundance of amenities. The picturesque Bridgewater Canal flows nearby where you can enjoy nature walks or boat rides. The area boasts an array of reputable schools and leisure facilities as well as excellent transport links including the new direct busway into Manchester. The demand for this area has never been so strong!

Entrance Porch

Reception Room

Dining Room

Kitchen Area

First Floor Landing

Bedroom One

En-suite Bathroom

Bedroom Two

Bedroom Three

Family Bathroom

Floorplan

Rear Garden

Council Tax

Salford City Council, Band C, £1,871 PA.

External

Your-Move.co.uk Ltd., 01864469, Newcastle House Albany Court, Newcastle Business Park, Newcastle Upon Tyne, NE4 7YB

All Measurements
All Measurements are Approximate.

Laser Tape Clause
All measurements have been taken using a laser tape measure and therefore, may be subject to a small margin of error.

Floorplan Clause
Measurements are approximate. Not to Scale. For illustrative purposes only.



For full EPC please contact the branch.

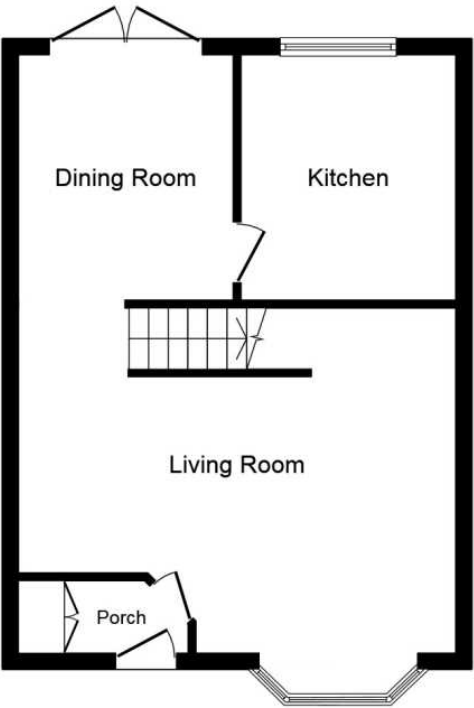

Ground Floor

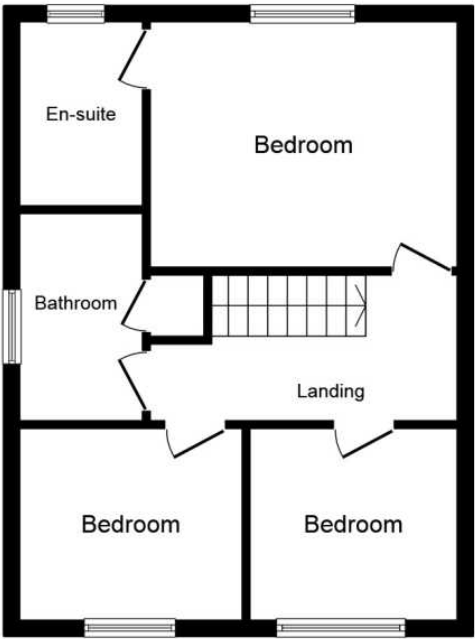

First Floor

Total floor area 89.9 sq.m. (967 sq.ft.) approx
This floor plan is for illustrative purposes only. It is not drawn to scale. Any measurements, floor areas (including any total floor area), openings and orientation are approximate. No details are guaranteed, they cannot be relied upon for any purpose and they do not form part of any agreement. No liability is taken for any error, omission or misstatement. A party must rely upon its own inspection(s).
Plan produced for Your Move. Powered by www.focalagent.com