

Mill Close, Nash Mills, Hemel Hempstead, Hertfordshire, HP3

Offers Over: £400,000

Tenure: Freehold



your-move.co.uk

Mill Close, Nash Mills, Hemel Hempstead, Hertfordshire, HP3

Offers Over: £400,000 Tenure: Freehold

Council Tax Band: C

EPC Rating: D

* OVER 1100 SQ FT * LONG GARAGE & OFF RD PARKING * G/FLOOR CLOAKROOM * SPACIOUS LIVING ROOM * CLOSE TO GOOD SCHOOLS * CLOSE TO TRAIN STATION * CUL-DE-SAC LOCATION * FITTED KITCHEN * GAS CENTRAL HEATING * UPVC DOUBLE GLAZING * EASY ACCESS TO A41/M25/A414/M1 * EPC Grade D

Location

Mill Close is a quiet cul-de-sac, in the popular Nash Mills area. Close by you have a good selection of local nursery, junior and senior school. Local shops are within short walking distance, making this a great location for a young family. Situated on the borders of Nash Mills, Apsley and Kings Langley, this is simply a great location for commuting. The closest train station (Apsley) provides a great service in to London and you are also just a few minutes drive from the A41 and M25.

Entrance Hall

Stairs to first floor, access to garage and door to:

Cloakroom

With sink and wc

Landing

open to:

Living Room

Large living space with windows to front, stairs leading to second floor and door to:

Kitchen

Fitted kitchen, built in oven, hob and space for more appliances.

Landing

With access to loft space and doors to:

Bedroom One

Double Bedroom with window to front and built in cupboard space

Bedroom Two

Double Bedroom with window to rear and built in cupboard space

Bedroom Three

Single Bedroom with window to front

Bathroom

With bath, wc, sink, tiled walls

Driveway

Providing off road parking for one car

Garage

Double length garage to front of the property with up and over door, light and power

Rear Garden

Large plot with patio area to the side and laid to lawn

Your Move is a trading name, independently owned and operated under licence from your-move.co.uk Limited, by National Home Move Limited, (company number 11805074), registered in England at 5 Brooklands Place, Brooklands Road, Sale, M33 3SD. Return postal address - 65-66 Baxter Gate, Loughborough, LE67 2RF. VAT registration no: 315 255 523.

All Measurements
All Measurements are Approximate.

Laser Tape Clause
All measurements have been taken using a laser tape measure and therefore, may be subject to a small margin of error.

Floorplan Clause
Measurements are approximate. Not to Scale. For illustrative purposes only.



For full EPC please contact the branch.

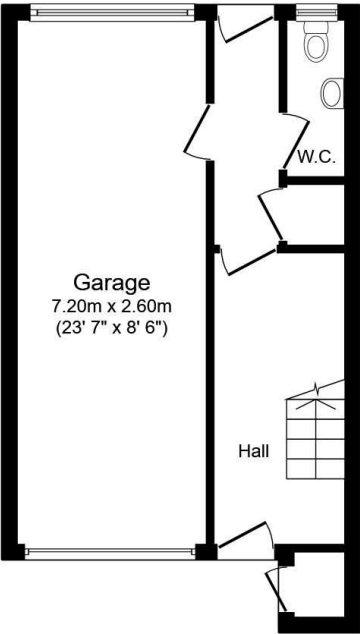

Ground Floor

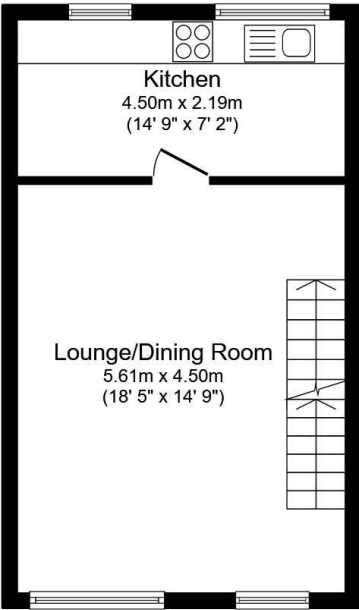

First Floor

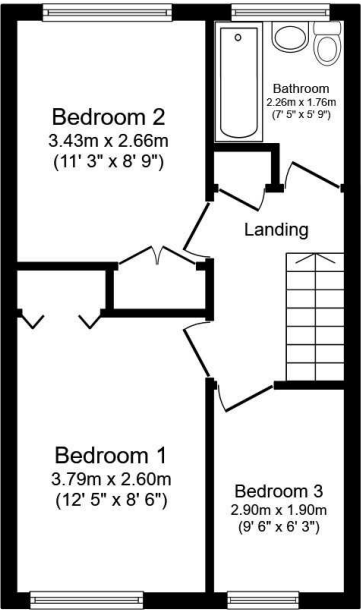

Second Floor

Total floor area 103.9 sq.m. (1,118 sq.ft.) approx

This floor plan is for illustrative purposes only. It is not drawn to scale. Any measurements, floor areas (including any total floor area), openings and orientation are approximate. No details are guaranteed, they cannot be relied upon for any purpose and they do not form part of any agreement. No liability is taken for any error, omission or misstatement. A party must rely upon its own inspection(s).
Plan produced for Your Move. Powered by www.focalagent.com

We may refer you to recommended providers of ancillary services such as Conveyancing, Mortgages, Insurance and Surveying. We may receive a referral fee for recommending their services. You are not under any obligation to use the services of the recommended provider, which may also be an associated company of Your Move.