

Amalfi Tower, Sunderland

Offers in the region of:
£68,000 Leasehold



your-move.co.uk

Amalfi Tower, Sunderland
Offers in the region of: £68,000 Leasehold

Description

**** Rarely Available ** Ground Floor Flat **
Lovely Outlook ** Two Bedrooms ** Secure
Telecom Entry System ** Communal Gardens
** Well Maintained ** EPC Rating C ****
A delightful two bedroom ground floor flat
located within Amalfi Tower, Silksworth.

Your-Move.co.uk Ltd., 01864469, Newcastle House Albany Court,
Newcastle Business Park, Newcastle Upon Tyne, NE4 7YB

All Measurements
All Measurements are Approximate.

Laser Tape Clause
All measurements have been taken using a laser tape measure and
therefore, may be subject to a small margin of error.

Floorplan Clause
Measurements are approximate. Not to Scale. For illustrative
purposes only.

Location

Located in the ever popular Lakeside village
estate in Silksworth, this property is ideally
located for Sunderland city centre and
surrounding areas. Silksworth benefits from a
range of amenities including shops, bars and
schools as well as the well known dry ski
slope. Further amenities can be found in
Sunderland city centre which is accessible by
good bus links in the area.

Entrance Hall

Lounge

14'11" x 14'2" (4.55m x 4.32m)

Kitchen

5'9" x 11'8" (1.75m x 3.56m)

Bedroom One

11'3" x 10'2" (3.43m x 3.1m)

Bedroom Two

11'3" x 7' (3.43m x 2.13m)

Bathroom

5'6" x 7'5" (1.68m x 2.26m)

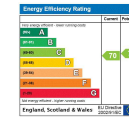

For full EPC please contact the branch.

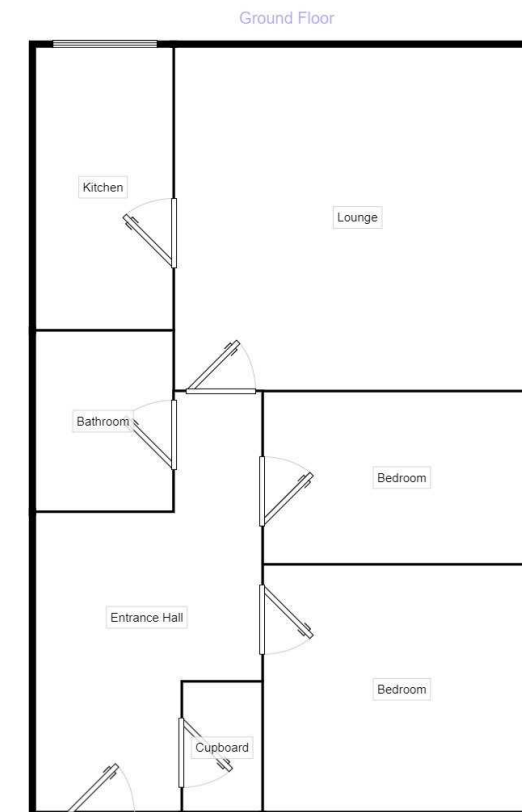

Measurements are approximate. Not to scale. For illustrative purposes only.