



Etterby Terrace, Carlisle, Cumbria
Asking Price: £135,000



your-move.co.uk

Carlisle T: 01228 537333



1 Etterby Terrace, Carlisle, Cumbria

Asking Price: £135,000

A substantial double fronted terrace house located in the desirable location to the north of the river. Recently refurbished the property comprises, two reception rooms, modern galley kitchen leading to rear hall and bathroom. To the first floor there are two double bedrooms, the property has gas central heating, double glazing and shared access to the rear. EPC rating is grade D.

Entrance Hall

Reception Room
14'2"x10'5" (4.32mx3.18m)

Reception Room
14'3"x11'8" (4.34mx3.56m)

Kitchen
9'2"x5'3" (2.8mx1.6m)

Rear Hall

Bathroom

First Floor

Bedroom
14'3"x11'8" (4.34mx3.56m)

Bedroom
10'6"x9'2" (3.2mx2.8m)

Outside

Flooplan Clause: measurements are approximate. Not to Scale. For illustrative purposes only.

For full EPC please contact the branch.

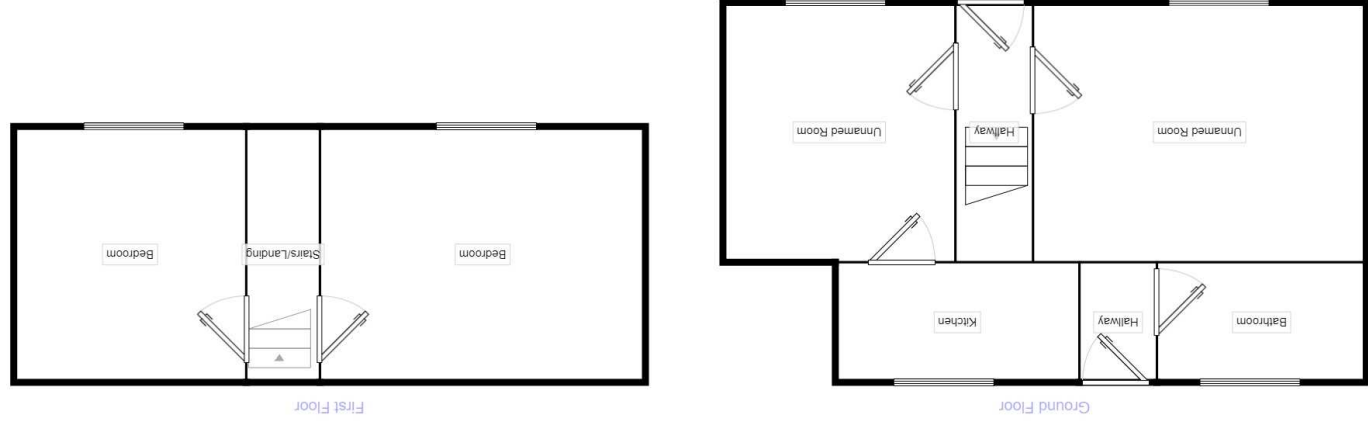

Measurements are approximate. Not to scale. For illustrative purposes only.

Your-Move.co.uk Ltd., 01864469, Newcastle House Albany Court, Newcastle Business Park, Newcastle Upon Tyne, NE4 7YB

All measurements are approximate and have been taken using a laser tape measure and therefore, may be subject to a small margin of error.

We may refer you to recommended providers of ancillary services such as Conveyancing, Mortgages, Insurance and Surveying. We may receive a referral fee for recommending their services. You are not under any obligation to use the services of the recommended provider, which may also be an associated company of Your Move.