

Corporation Road, Gillingham,
Kent, ME7

£950 per month

Unfurnished



your-move.co.uk

Corporation Road, Gillingham, Kent, ME7
£950 per month Unfurnished

Zero Deposit Guarantee available at Your Move
Beautiful two bedroom house ideal for first time renters. The accommodation comprises a separate lounge, diner and kitchen. The garden is accessible from the kitchen. The first floor has two double bedrooms with a family bathroom. Call us NOW to book your viewing. Council Tax Band B. EPC Grade D.

Description

Zero Deposit Guarantee available at Your Move
Beautiful two bedroom house ideal for first time renters. The accommodation comprises a separate lounge, diner and kitchen. The garden is accessible from the kitchen. The first floor has two double bedrooms with a family bathroom. Call us NOW to book your viewing. Council Tax Band B. EPC Grade D.

Location

The historic town of Gillingham benefits from national railway links to London Bridge, Victoria, Waterloo and high-speed to St. Pancras International train station which is under 1 hour commute. You can also catch a train to many Kent coastal towns such as Margate in under 1 hour. The high street has a selection of convenience stores, restaurants as well as a Costa Coffee. Gillingham has its very own football club and also benefits from the Great Lines Heritage Park, University of Kent Campus, Medway Park Sports Centre and Grammar schools.

Ideally placed for Gillingham town centre with its mainline station to London and the South East coast and splendid variety of shops. Gillingham sports complex is approximately half a mile distance with its in door heated swimming pool and numerous sporting activities. The Strand is approximately half a mile distance with its out door pool and many leisure activities as well as many pleasant river side walks. The A2, M2 motorway networks are also within a short driving distance and the

popular dockside retail outlets centre is also within three quarters of a mile.

Entrance Hall

Lounge

Kitchen

Dining Room

Bathroom

Stairs To:-

Master Bedroom

Bedroom Two

Rear Garden

Your-Move.co.uk Ltd., 01864469, Newcastle House Albany Court, Newcastle Business Park, Newcastle Upon Tyne, NE4 7YB

All Measurements
All Measurements are Approximate.

Laser Tape Clause
All measurements have been taken using a laser tape measure and therefore, may be subject to a small margin of error.

Floorplan Clause
Measurements are approximate. Not to Scale. For illustrative purposes only.



For full EPC please contact the branch.

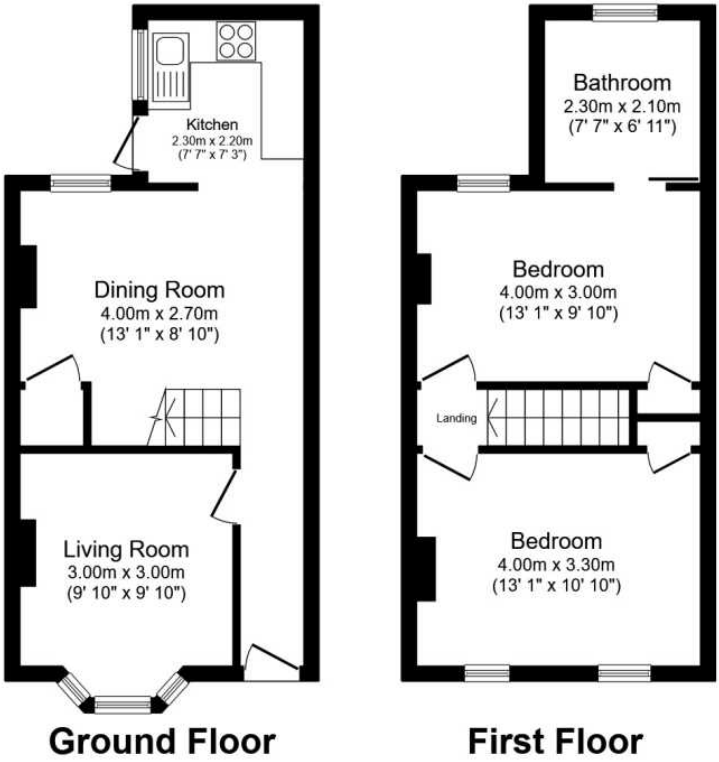

Total floor area 64.7 sq.m. (697 sq.ft.) approx
This floor plan is for illustrative purposes only. It is not drawn to scale. Any measurements, floor areas (including any total floor area), openings and orientation are approximate. No details are guaranteed, they cannot be relied upon for any purpose and they do not form part of any agreement. No liability is taken for any error, omission or misstatement. A party must rely upon its own inspection(s).
Plan produced for Your Move. Powered by www.focalagent.com