

Galway Mews, Harworth,
Doncaster, South Yorkshire, DN11

£800 per month

Unfurnished



your-move.co.uk

Doncaster T: 01302 340444



Galway Mews, Harworth, Doncaster, South Yorkshire, DN11
£800 per month Unfurnished

Description

ZERO DEPOSIT GUARANTEE AVAILABLE...

If you are looking for modern spacious accommodation set over three floors then look no further. This property offers modern spacious living throughout and briefly comprises to the ground floor an entrance hall, down stairs WC, kitchen boasting white fitted units giving soft close drawers and cupboards along with integral appliances. Also there is an open plan living dining area. To the first floor are two good size bedrooms along with a family bathroom. To the second floor there is a further double bedroom. Externally the property has off street parking along with front and rear gardens and this property must be viewed to appreciate the standard of accommodation on offer.

EPC rating B
Council Tax Band B

Location

Harworth can be found approximately six miles outside of Doncaster's Town Centre and is served by excellent range of local amenities including shops, schooling, supermarkets, as well as regular bus services to and from Doncaster's Town Centre.

Our View

Fantastically located for commuters along with an excellent range of amenities, this property will not be around for long, book your viewing early to avoid disappointment.

Entrance Hall

1.78 x 3.18

Downstairs W/C

1.78 x .89

Kitchen

2.57 x 3.07

Living/Dining Room

4.44 x 4.9

First Floor Landing

1.78 x 4.09

Bedroom 2

4.47 x 3.02

Family Bathroom

2.57 x 1.73

Bedroom 3

2.59 x 2.21

Bedroom 1

3.48 x 5.16

Your-Move.co.uk Ltd., 01864469, Newcastle House Albany Court, Newcastle Business Park, Newcastle Upon Tyne, NE4 7YB

All Measurements
All Measurements are Approximate.

Laser Tape Clause
All measurements have been taken using a laser tape measure and therefore, may be subject to a small margin of error.

Floorplan Clause
Measurements are approximate. Not to Scale. For illustrative purposes only.



For full EPC please contact the branch.

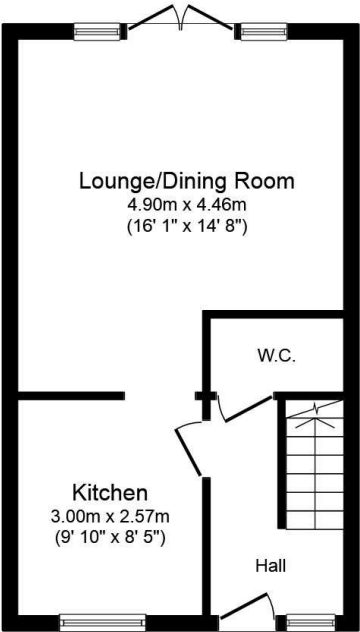

Ground Floor

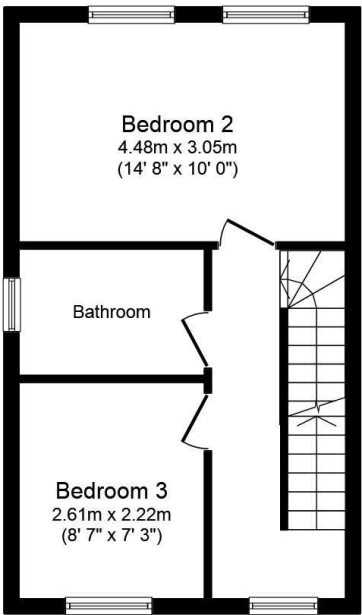

First Floor

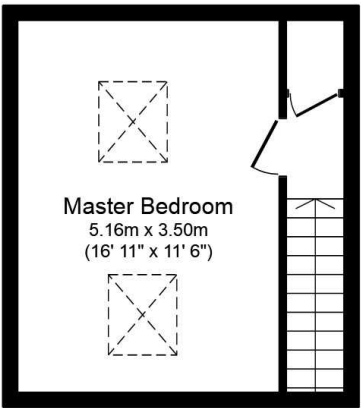

Second Floor

Total floor area 95.0 sq. m. (1,023 sq. ft.) approx
This plan is for illustration purposes only and may not be representative of the property. Plan not to scale.

Powered by audioagent.com

We may refer you to recommended providers of ancillary services such as Conveyancing, Mortgages, Insurance and Surveying. We may receive a referral fee for recommending their services. You are not under any obligation to use the services of the recommended provider, which may also be an associated company of Your Move.